

## End Clamp, Standard 30mm with W module, Length 50mm

### Assembly

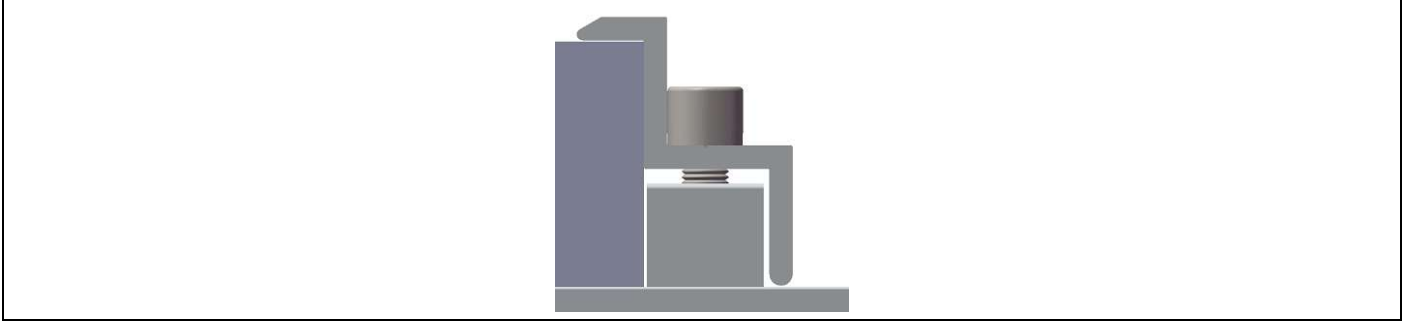

### Component



End Clamp, Standard 30mm with W module, Length 50mm - Part No.: ER-EC-W30  
(bar code: 10-006-01685)

### Technical Specification

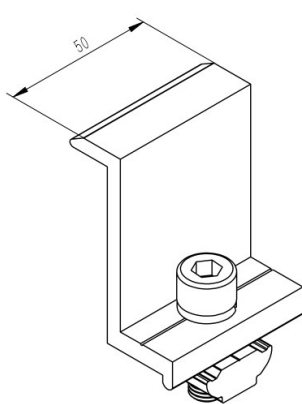
Application	For framed PV Modules of 30mm in height	
Requirement	Needs 20mm space on each side of the Rail	
Dimensions	L50mm	
Weight	0.056 Kg	
Packaging	80 units per pack, 4 packs (320 units) per carton	
Material	Main parts: AL6005-T5 Bolts/Washers: SUS 304	
Color	Silver	
Finish	Anodized (no less than 10 µm, excluding machined surfaces)	
Standard	GB 50797   AS NZS 1170.2   EN 1991   JISC 8955   ASCE 7-10	

## Angle AL-50.8\*50.8\*2580 with bolt hole Ø8.5

### Assembly

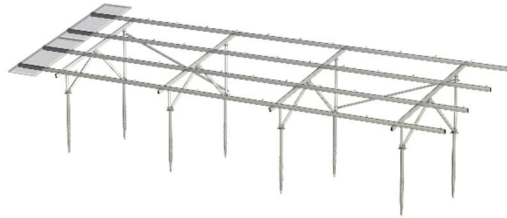

Fix on the Girder

### Component



Angle AL-50.8\*50.8\*2580 with bolt hole Ø8.5 - Part No.: ER-AA-50/2580/8  
(bar code: 10-117-00525)

### Technical Specification

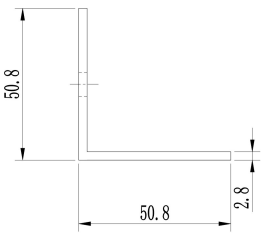
Application	Compatible with Clenergy STEco	
Fixing Method	Fixing with bolts to Support	
Dimension	L2580mm*W50.8mm*H50.8mm	
Weight	1.927kg	
Packaging	700 pcs per pallet	
Material	AL6005-T5	
Color	Silver (half-anodized no less than 10 µm)	
Standard	GB 50797   AS NZS 1170.2-2011   EN 1991   JISC 8955   ASCE 7-10	

## Cap for TW-Rail 100

### Component

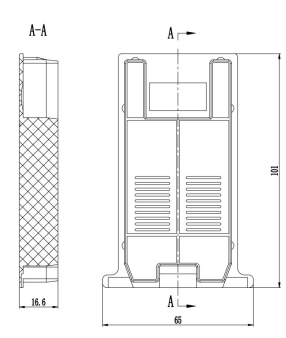

### Technical Specification

Application	Compatible with Clenergy STEco	
Fixing Method	Fixing at the end of the Rail	
Dimension	L101mm*W65mm*H16.6mm	
Weight	0.017kg	
Packaging	60 units per pack, 4 packs (240 units) per carton	
Material	PA6 +GF20%+ UV0.5%	
Color	Black	
Standard	GB 50797   AS NZS 1170.2-2011   EN 1991   JISC 8955   ASCE 7-10	

## PV-ezRack Connector for Rectangular Tube 55\*50

### Assembly



Connect with Rectangular Tube

### Component



PV-ezRack Connector for Rectangular Tube 55\*50 - Part No.: CO-RT-55/50  
(bar code: 10-007-00016)

### Technical Specification

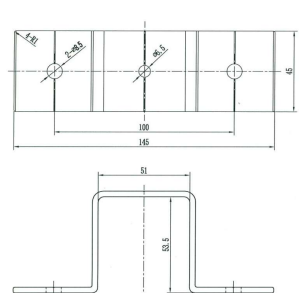
Application	Compatible with Clenergy STEco	
Fixing Method	Connect with Rectangular Tube	
Dimension	L145mm*W45mm*H53.5mm	
Weight	0.226kg	
Packaging	72 pcs per carton	
Material	AL6005-T5	
Color	Silver (half-anodized no less than 10 μm)	
Standard	GB 50797   AS NZS 1170.2-2011   EN 1991   JISC 8955   ASCE 7-10	

## Ground Screw Ø76\*3.0\*1800mm

### Assembly



Connect with Support

### Component



Ground Screw Ø76\*3.0\*1800mm, with Circular flange (D200) and Continuous Small blade - Part No.: GS-76/3.0/18-G0 (bar code: 11-012-00083)

### Technical Specification

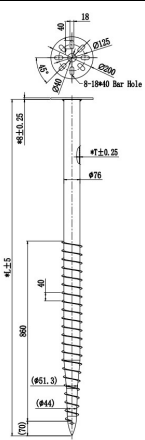
Application	Compatible with Clenergy STEco	
Fixing Method	Connect with Support	
Dimension	Ø76*T3.0*L1800mm	
Weight	12.152 kg	
Packaging	88 pcs per pallet	
Material	Q235B	
Color	Silver	
Standard	GB 50797   AS NZS 1170.2-2011   EN 1991   JISC 8955   ASCE 7-10	

## Hexagonal Bolt M16\*50, with nut and washer

### Component



Hexagonal Bolt M16\*50, with nut and washer - Part No.: ER-HB-ST16/50A  
(bar code: 12-011-00136)

### Technical Specification

Application	Compatible with Clenergy STEco	
Dimension	M16*50mm	
Weight	0.167kg	
Packaging	150 units per carton	
Material	SUS304	
Color	Silver	
Standard	GB 50797   AS NZS 1170.2-2011   EN 1991   JISC 8955   ASCE 7-10	

## Inter Clamp II, for Frame Height 30-32mm with W module, Length 50mm

### Assembly

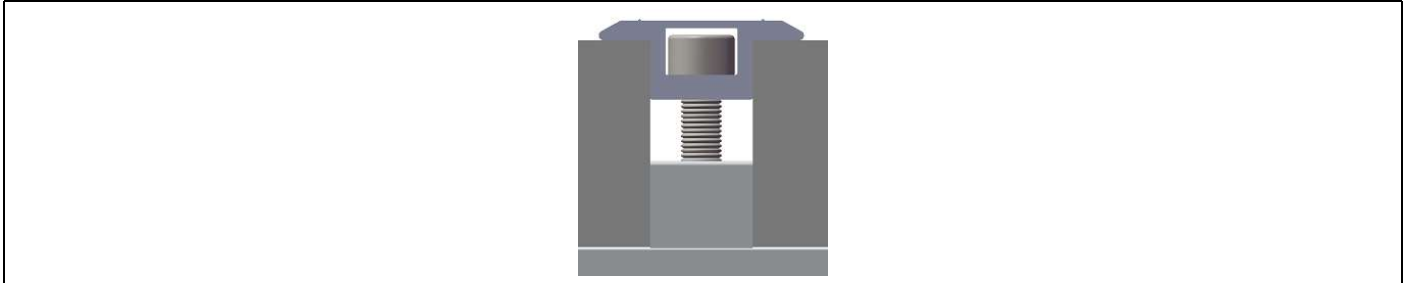

### Component



Inter Clamp II, for Frame Height 30-32mm with W module, Length 50mm - Part No.: ER-ICII-W30/32  
(bar code: 10-006-01686)

### Technical Specification

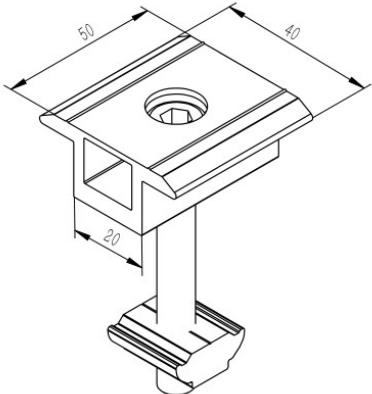
Application	For framed PV Modules of 30-32mm in height	
Requirement	Needs 20mm space between PV Modules	
Dimensions	L50mm*W40mm	
Weight	0.067 kg	
Packaging	80 units per pack, 4 packs (320 units) per carton	
Material	Main Structure: AL6005-T5 Fasteners: SUS 304	
Color	Silver	
Standard	GB 50797   AS NZS 1170.2   EN 1991   JISC 8955   ASCE 7-10	

## ST Eco, Support (Pre-assembled, W shape) 25 degree

### Assembly



Connect with Rail

### Component



SolarTerrace Eco, Support (Pre-assembled, W shape) 25 degree - Part No.: S-Eco/W/25/92/3  
(bar code: 10-018-00240)

### Technical Specification

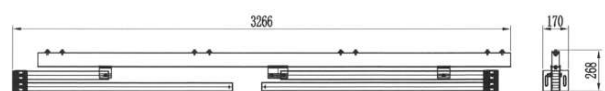
Application	Compatible with Clenergy STEco	
Tilt Angle	25°	
Dimension	L3266mm*W170mm*H268mm	
Weight	13.412kg	
Packaging	27 pcs per pallet	
Material	AL6005-T5	
Color	Silver (half-anodized no less than 10 μm)	
Standard	GB 50797   AS NZS 1170.2-2011   EN 1991   JISC 8955   ASCE 7-10	

## TW-Rail 100

### Assembly



### Component

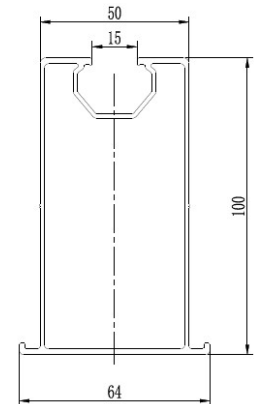

### Technical Specification

Application	Compatible with Clenergy STEco	
Fixing Method	Fixing with Rail Clamp	
Dimension	Lmm*W64mm*H100mm	
Weight	1.489kg/m	
Packaging	144 pcs per pallet	
Material	AL6005-T5	
Color	Silver (half-anodized no less than 10 μm)	
Standard	GB 50797   AS NZS 1170.2-2011   EN 1991   JISC 8955   ASCE 7-10	